

PARSIFAL
YACHTING



HAG • CUSTOM LINE 30.8M



DESCRIPTION

M/Y HAG is a 30.8m Custom Line, combining timeless Italian design with a comprehensive 2025 refit that significantly enhances both her technical performance and onboard comfort.

Designed by Zuccon International Project, she features a semi-displacement GRP hull and a well-balanced tri-deck layout, offering smooth cruising and practical living spaces throughout.

Her interiors have been fully refreshed with new furnishings, upgraded finishes, and improved lighting, creating a clean, contemporary atmosphere. The main salon benefits from ample natural light and modern AV systems, offering a comfortable setting for relaxation and socializing.

She accommodates up to 8 - 10 guests in four en-suite cabins, including a full-beam Master suite, a VIP cabin, and two convertible Twin/Double cabins with Pullman berths — ideal for flexible guest arrangements.

Following her extensive 2025 upgrades, including new air conditioning, updated systems, and new water toys, HAG is presented in excellent condition and ready for immediate cruising with a professional crew of six.

KEY FEATURES

- Extensive 2025 refit with major technical & aesthetic upgrades
- Excellent overall condition, ready for immediate use
- Flexible 4-cabin layout for up to 10 guests
- Full-beam Master suite with walk-in wardrobe
- New air conditioning system & upgraded AV/telecommunications
- Stabilizers at anchor & underway for enhanced comfort
- Jacuzzi on deck
- New GRAND tender (2025) & latest generation water toys
- Modern Sonos sound system across all decks
- Experienced crew of 6



SPECIFICATIONS

Length
30.80 m (101' 1")

Beam
7.00 m (23')

Drafft
2.2 m (7' 5")

Built
2007

Refit
2025

Builder
Custom Line

Guests
8 - 10 in 4 cabins

Total Crew
6

Main Engines & Generators

Engines
2x X MAN V12 (2 X 1360 HP)

Engines Consumption
340ltr/hr

Generators
2 x Kohler 33kW

Generators Consumption
200 ltrs/day

Cruising Speed
14 knots

Fuel Consumption
340ltrs/hr @cruising speed

Zero Speed Stabilizers

Audio Visual Equipment and Deck Facilities:

4/5G Internet connection

Wi-Fi

Radio & CD music system

Exterior sound system JL AUDIO

TV (saloon): 55" SAMSUNG

TV (cabins): 3 x 50" SAMSUNG
+ 2 x 32" SAMSUNG

Sat Antenna: KNS (90 CM)

Tenders & Water Toys

Tender Grand 4.2m with Mercury 50hp

Jet Ski Seadoo Spark

Sea bob (F9S, 2025)

Sea bob (F9,2025)

2 x SUPS

2 x Tubes

Wakeboard

Water Ski

Snorkeling equipment

2025 Refit Details

- Installation of new telecommunication devices
- RINA class certification
- New anchor chains
- Installation of decorative Alcantara upholstery / new leather headboards / leather finishes on salon shelves
- Maintenance & gold-plating of bathroom accessories / faucets & handles throughout the yacht
- Electric wooden blinds in the salon
- Fire detection system upgrade
- New sconces in salon and cabins, bronze-marble
- New Tender GRAND 460 with Mercury 50 engine
- Polishing of hull & superstructure
- New modern lifesaving equipment
- New modern radar system
- General repair - hydraulic piping works throughout the yacht
- Complete replacement of starboard exhaust
- Upgrade of stainless-steel external yacht areas
- Modern battery charger & new cabling
- Installation of new telecommunication devices (second line item)
- New heavy-duty ropes
- New chef serving sets and kitchenware
- Installation of new carpet, 100% wool, handmade
- Yacht Beach luxury pool
- New salon furniture with built-in refrigerators & automatic bottle display, bar/cabinet, ice maker setup, two square salon tables, general wooden surface repair throughout yacht
- Installation of new modern PSS shaft seals
- Change of furniture (new custom salon sofa, new armchairs, new dining chairs, new cabin stools, new cushions for interior and exterior areas)
- Latest model Jet Ski Yamaha Cruiser SVHO with black speakers
- Latest model Seabob F9 & F9S in white color
- New televisions
- New Sonos sound systems and speakers across all decks
- Replacement of all gangway sensors
- Crane remote control
- Crane circuit board replacement
- New cabling / LED lights interior & exterior / smart features / new exterior spotlights
- Complete replacement of yacht air conditioning units / Webasto
- Gyro overhauling





MAIN DECK

The main deck of M/Y HAG offers a refined and well-balanced environment, combining contemporary upgrades with the yacht's original Italian design.

The salon has been fully refreshed with new custom furnishings, including a redesigned sofa arrangement, new armchairs, and upgraded finishes throughout. Large windows allow natural light to flow in, enhancing the warm tones of the interior and creating a bright, inviting atmosphere. New electric wooden blinds and updated lighting fixtures add both comfort and functionality, allowing the space to adapt easily from daytime relaxation to evening ambiance.

The dining area is seamlessly integrated within the salon, offering a comfortable and elegant setting for indoor meals, while remaining connected to the main lounge. Upgraded audio-visual systems and discreet smart features enhance the onboard experience without overwhelming the design.

Sliding glass doors open onto the aft deck, where shaded seating and alfresco dining extend the living space outdoors. The connection between interior and exterior areas is fluid and practical, allowing guests to move effortlessly between relaxation, dining, and access to the sea.

SALOON









DINING AREA







GALLEY







LOWER DECK / ACCOMMODATION

The lower deck of M/Y HAG is designed with a strong focus on comfort, functionality, and guest flexibility.

She accommodates up to 8 to 10 guests in four en-suite cabins. The full-beam Master suite offers a spacious and private retreat, featuring a king-size bed, walk-in closet, and a dedicated vanity area. The VIP cabin is equally well-appointed, with a queen-size bed and generous storage, providing a comfortable secondary suite.

The two additional guest cabins are designed for versatility, easily converting between Twin and Double configurations. Each includes a Pullman berth, making them ideal for accommodating families, children, or additional guests without compromising comfort.

Following the 2025 refit, all cabins have been upgraded with new soft furnishings, improved lighting, and refined material finishes. Bathrooms have also been refreshed, with upgraded fittings and detailing, ensuring a consistent and well-maintained standard throughout the accommodation areas.



MASTER CABIN









VIP CABIN











TWIN CABIN







TWIN CABIN











EXTERIOR

M/Y HAG's exterior spaces are thoughtfully arranged to offer a variety of areas for relaxation, dining, and entertainment throughout the day.

The aft deck provides a comfortable alfresco dining area, directly connected to the salon, making it ideal for casual meals or evening gatherings. Just below, the swim platform offers easy access to the water and serves as a central point for enjoying the yacht's water toys.

The sundeck is one of the yacht's key social areas, featuring generous sunbathing spaces, lounge seating, and a deck Jacuzzi. It offers both open sun and shaded areas, allowing guests to enjoy the space at any time of day.

Forward, the bow area provides an additional, more private lounging space with sunpads, ideal for quiet moments at anchor or while cruising.

Overall, the exterior layout delivers a practical and relaxed onboard lifestyle, combining comfort, privacy, and ease of use across all decks.



AFT







UPPER DECK









SUNDECK















BOW









GENERAL ARRANGEMENT

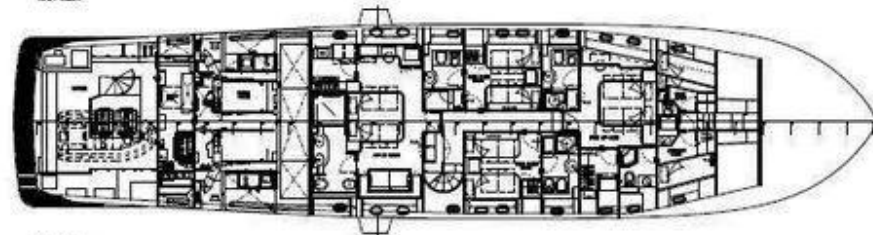
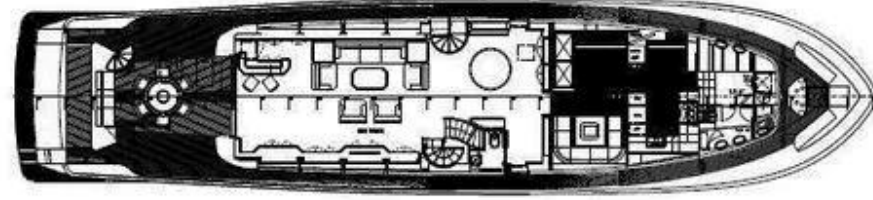
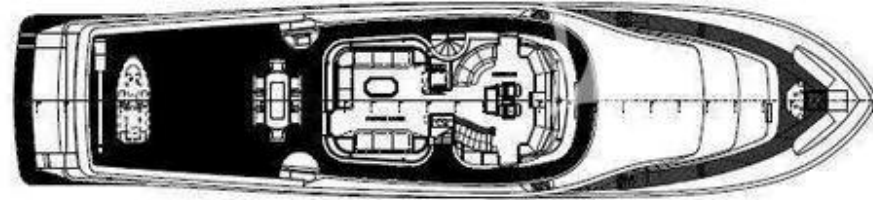
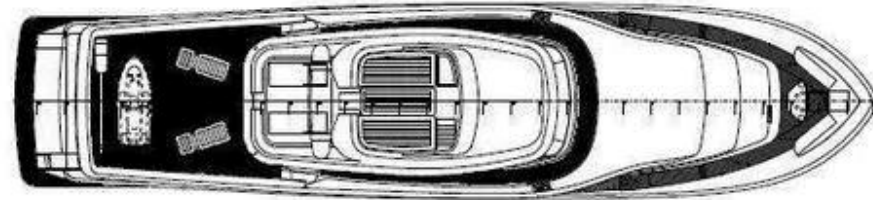

<input checked="" type="checkbox"/> ZUCCONI INTERNATIONAL PROJECT #21	
21/000000 - 01 - 0000 - 01 - 000000 - 01 - 000000	
PROJECT NAME	
CLIENT	
ARCHITECT	
ENGINEER	
CUSTOM LINE ENGINEERING DEPT.	
GENERAL ARRANGEMENT	
DATE	SCALE
BY	CHKD
DATE	DATE
REVISIONS	
NO.	DESCRIPTION
1	



DISCLAIMER

The Company offers the details of this vessel in good faith but cannot guarantee or warrant the accuracy of this information nor warrant the condition of the vessel. A buyer should instruct his agents, or his surveyors, to investigate such details as the buyer desires validated. This vessel is offered subject to prior sale, price change, or withdrawal without notice.